

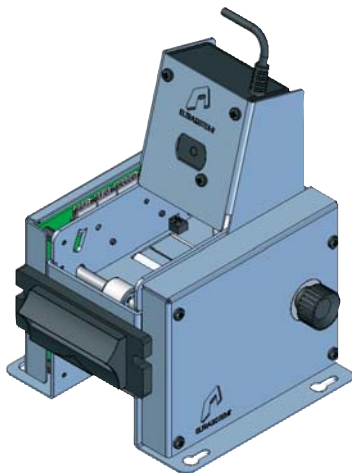

BTR – EL0000 SERIES - Barcode ticket reader



MAIN FEATURES

- Stepping motor and photosensors ticket positioning
- Easy BAR CODE scanner module replacement
- In line or transverse BAR CODE detection options
- Universal code symbologies process capability
- Microprocessor based electronics
- SMD low consumption electronic circuits
- Communication by means of RS232/RS485 serial interface

TECHNICAL SPECIFICATIONS

OVERALL DESCRIPTION

- **Outline dimensions:** 140(H) x 115(L) x 124(W) mm
- **Weight:** 1 Kg (Approximately)
- **Electronics:** Specific PCB
- **Ticket motion:** Stepping motor
- **Transport method:** Rolls
- **Ticket Sensors:** Photosensors
- **Output interface:** RS232 / RS485
- **Power requirements:** +24V DC +/-10% 10A

ENVIRONMENTAL

- **Operating temperature:** From 0 to +50°C
- **Storage temperature:** From -20 to +60°C
- **Relative humidity:** From 20 to 80% (No condensation)

TICKET SPECIFICATIONS

- **Paper:** Thermal paper
- **Length:** 85.60 mm
- **Width:** 53.98 mm
- **Thickness:** From 0.15 to 0.35 mm